

Floor Extensions

Overhanging floors are achieved by my new floor extension pieces. These extensions are half a brick in height, so when building your project, this needs to be taken into consideration. For example, the Tudor house ground floor uses No. 3 rods, so use only two layers of full tiles and one layer of half bricks. This leaves the required space to position the floor extensions as shown in illustration 1.

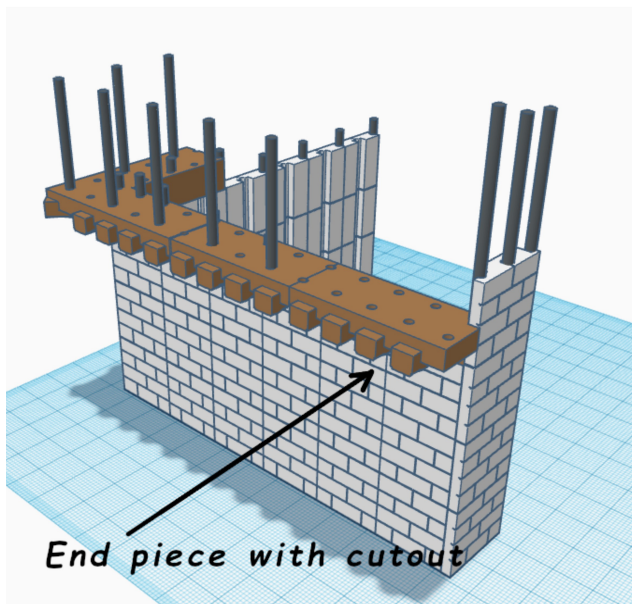

Illustration 2: End piece in place

achieved by using the corner and straight metal ties.

If you wish to extend the overhang around all sides is simple. The resulting floor plan will be one brick wider and longer than the ground floor. You can also just have the overhang along one, two or three sides. You will need to extension on a corner as in illustration 2.

Place rods into the outer holes to build higher (illustration 3). You may find that the rods are sometimes a little loose, but persist,. Once the brick tiles and windows are in place, they will give a stability. Better stability can be

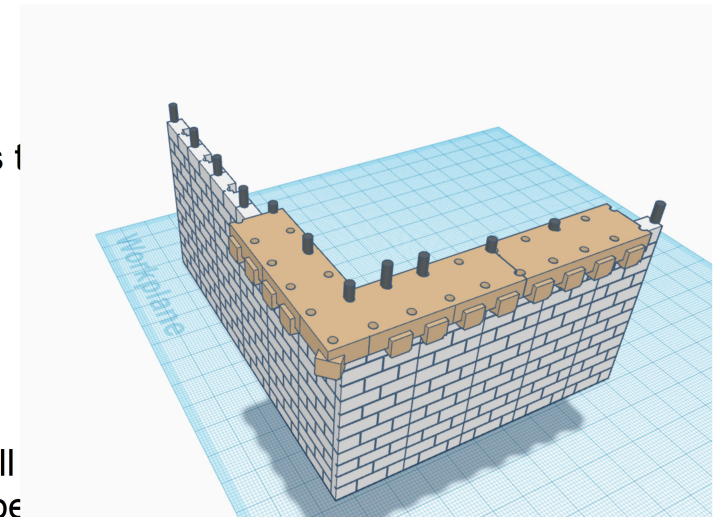

Illustration 1: Positioning the floor extensions

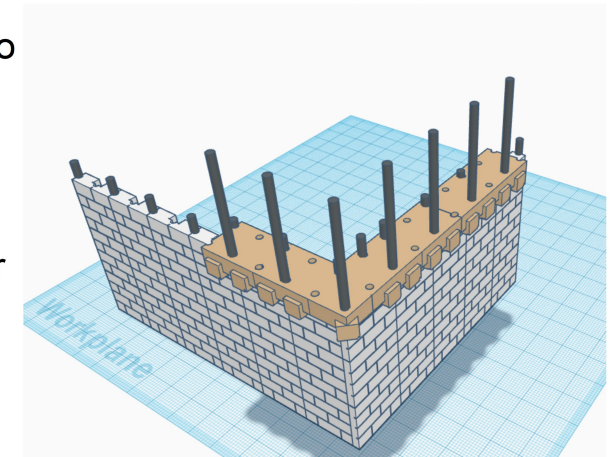

Illustration 3: Inserting rods into extension